

### Maintenance

Your new faucet is designed for years of trouble-free performance. Keep it looking new by cleaning it periodically with a soft cloth. Avoid abrasive cleaners, steel wool and harsh chemicals as these will scratch, dull, and/or damage the finish and/or product void your warranty.

### Safety Tips

Be sure to shut off water supply prior to installation. Protect your eyes with safety glasses when cutting or soldering water supply lines. Cover your drain to avoid losing parts.

### Important Points

Prior to beginning installation, turn off the cold and hot water lines and open the hot and cold knobs on the old faucet to release build-up pressure. When installing your new faucet, turn the connector nuts finger-tight, then use one wrench to anchor the fitting and a second wrench to tighten the nut one additional turn. Connections that are too tight will reduce the integrity of the system. Wrap all threaded connections with Teflon tape available at your local hardware or plumbing supplies store. Always wrap in a clockwise direction. All installations can vary depending on how your previous faucet was installed. Not all necessary supplies to install your faucet are included, however, they are available wherever plumbing supplies are sold.

### WE RECOMMEND INSTALLATION TO BE DONE BY QUALIFIED LICENSED PLUMBER

Prior to installation please read the instructions thoroughly, confirm that all parts are included and visually inspect the unit for any defects. If you have any questions, please contact Store Department before proceeding installation.

## Installation Instructions

### STEP 1

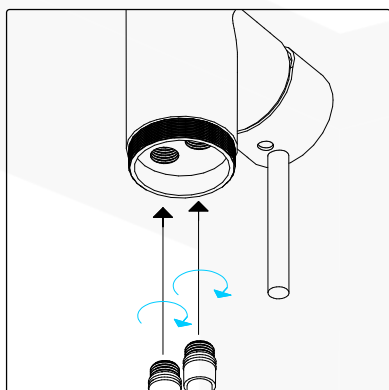

### STEP 2

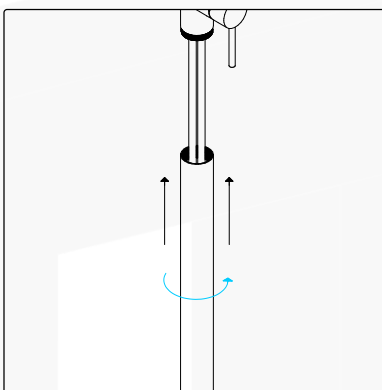

### STEP 3

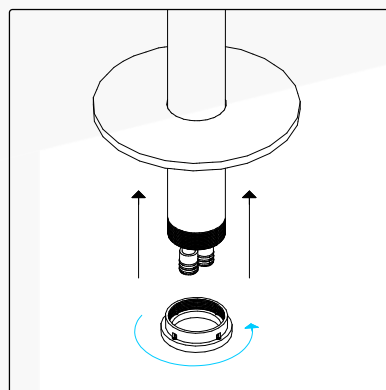

### STEP 4

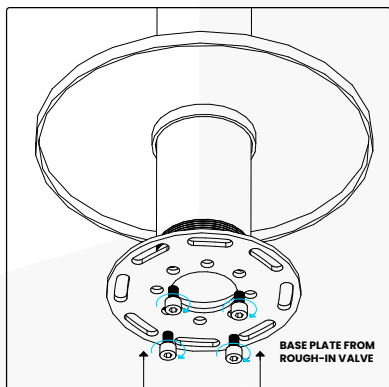

### STEP 5

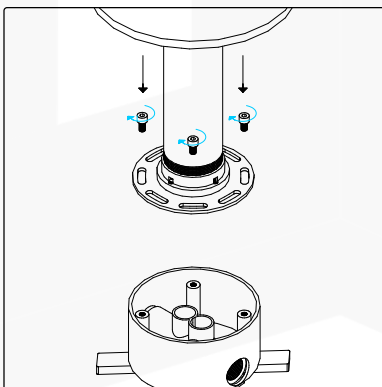

### STEP 6

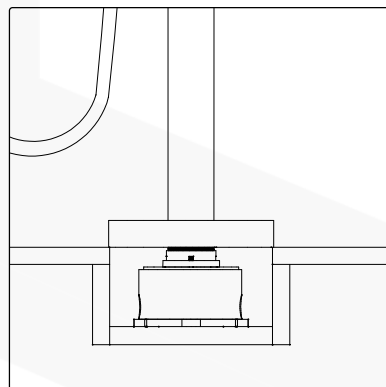

## ROUGH-IN VALVE

### OPERATING PRESSURE

Minimum: 15 psi

Maximum: 75 psi

Above 90psi it may be necessary to install a pressure reducer

### OPERATING TEMPERATURE

Maximum: 176°

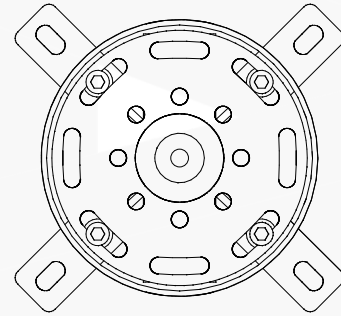

### STEP 1

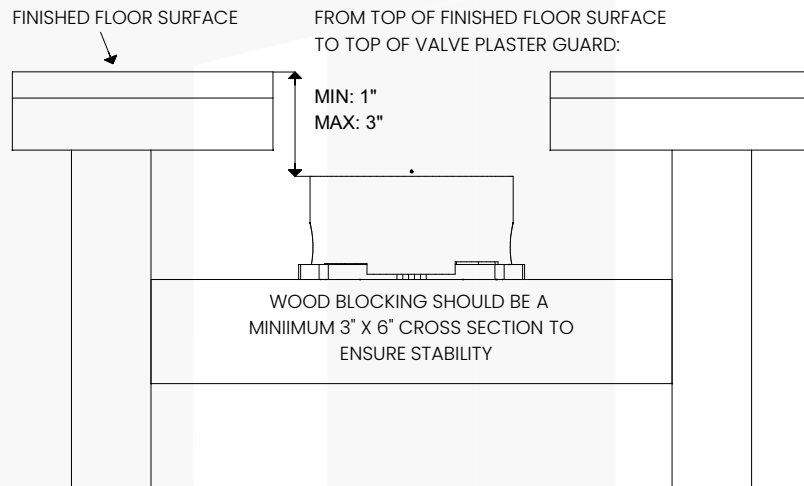

### STEP 2

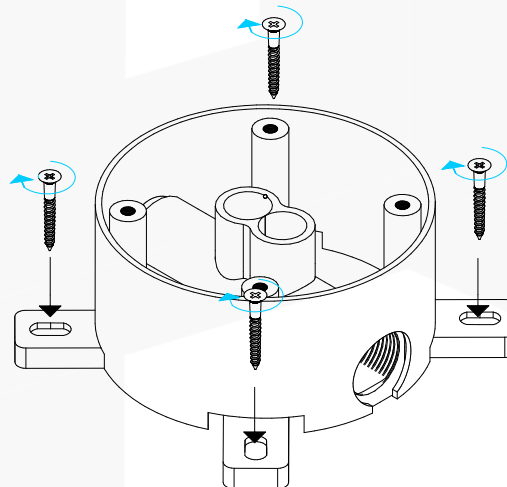

### STEP 3

ENSURE THAT THE HOT AND COLD SUPPLY LINES ARE CONNECTED TO THE CORRECT INLETS. 1/2" MALE-TO-MALE EXTENSIONS ARE PROVIDED FOR EASIER INSTALL IF NECESSARY.

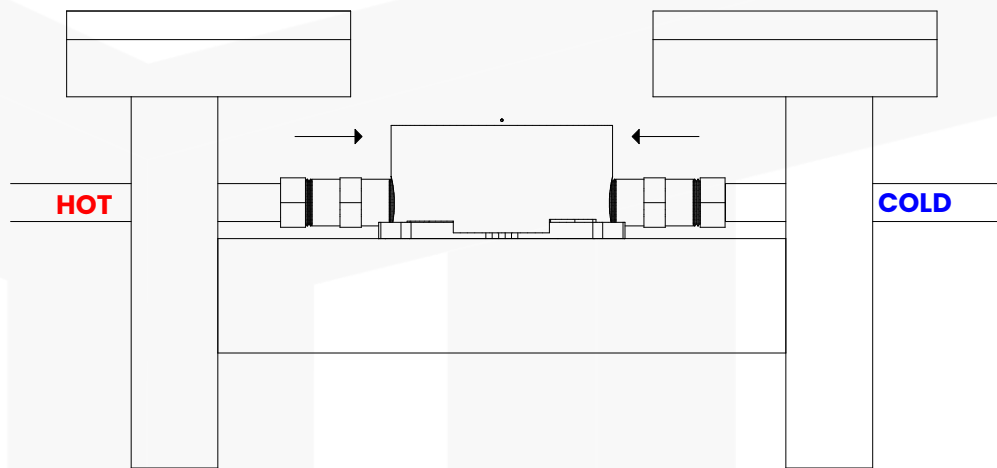

### STEP 4

REMOVE BASE PLATE USING ALLEN WRENCH PROVIDED

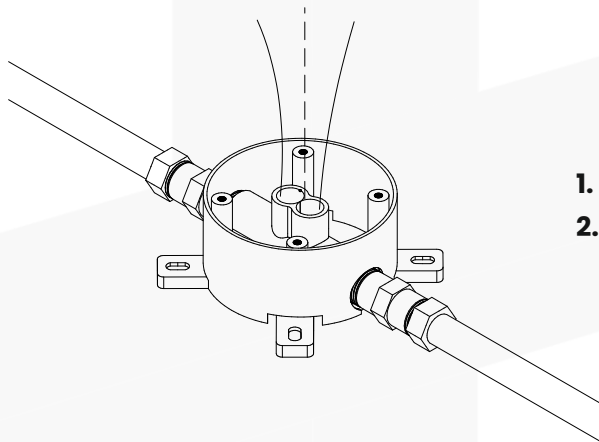

1. FLUSH TO CLEAR DEBRIS.
2. CHECK CONNECTIONS FOR WATER TIGHTNESS.



- 1** BASE PLATE SECURING SCREWS
- 2** BASE PLATE
- 3** BUBBLE LEVEL
- 4** VALVE BODY

